

ACOUSTIC INSULATION OF TERRACES AGAINST FOOT-TRAFFIC NOISE

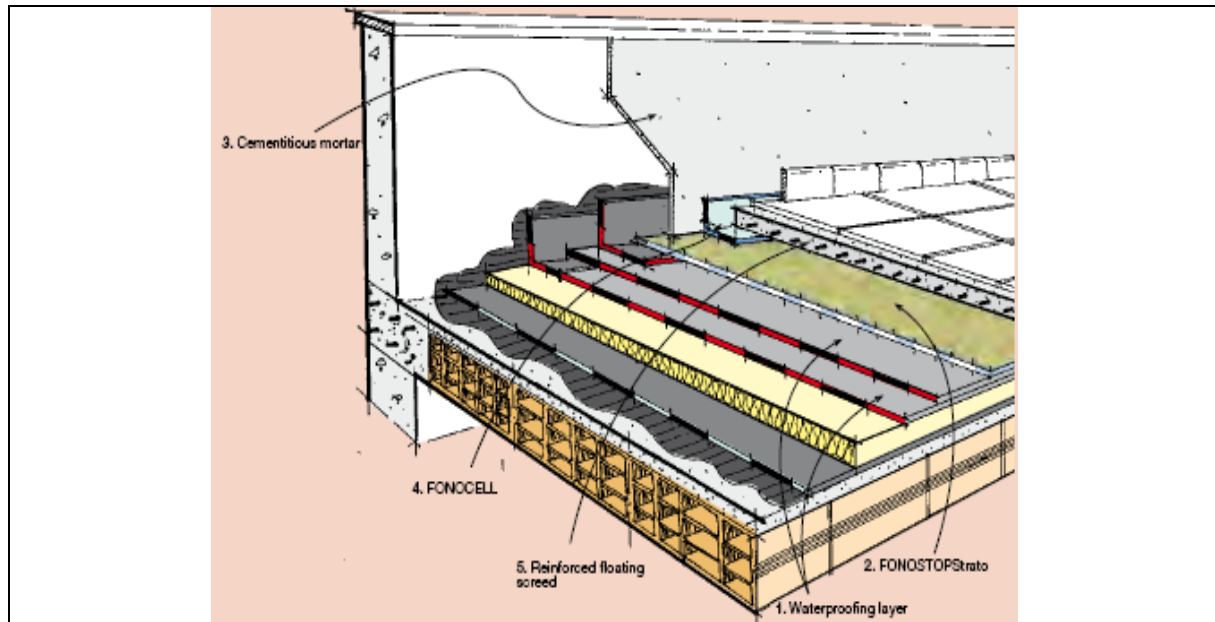

Insulation of terraces under floating screed

The acoustic insulation of terraces against foot-traffic noise will be performed with the "floating floor" technique on an acoustic insulation type **FONOSTOPStrato** made up of heat-sealed non-woven fabric coupled with non-woven polyester fabric with "elastic needling", with ultimate tensile stress $L/T=550/350$ N/50 mm and ultimate elongation $L/T=100/200\%$ supplied in 100 cm width rolls with 5 cm overlap wing. The sheets will be laid on the weatherproof layer, overlapping them by 5 cm longitudinally along the special overlap wing, while the head ends will just be carefully brought together. The sheets will be blocked and trimmed-off at the foot of the perimeter walls and around all the elements protruding from the surface of the floor. All the overlaps and joining lines will be sealed with the special adhesive SIGILTAPE. Once the vertical parts of the waterproof layer have been protected, the insulated strip in extruded polyethylene **FONOCCELL** will be glued on to them, which will descend to cover the sheets of **FONOSTOPStrato** laid previously on the flat part. The concrete screed reinforced with electrically welded mesh with thickness of more than 4 cm will then be cast on the insulation layer. Once the floor has been laid, the excess part of the strip of **FONOCCELL** will be trimmed-off and the skirting board will be laid, which must be detached from the floor.